

CONESTOGA HIGH SCHOOL

Daily Needs	Full Time	Part Time	Total	Comments
Teachers & Aides	163	3	166	
Itinerant Teachers & Staff				
Administration	6		6	
Support Staff / Sect.	14		14	
Visitors & Volunteers		12	12	
Service		5	5	
Custodial Staff	17		17	
Cafeteria Staff	12		12	
Students	300		300	
Paraprofessionals	32		32	
Tech Support	3		3	
Trainers	2		2	
IU Support		9	9	
Total			578	

Special Events

100-800

Current Solutions

Grass fields and streets

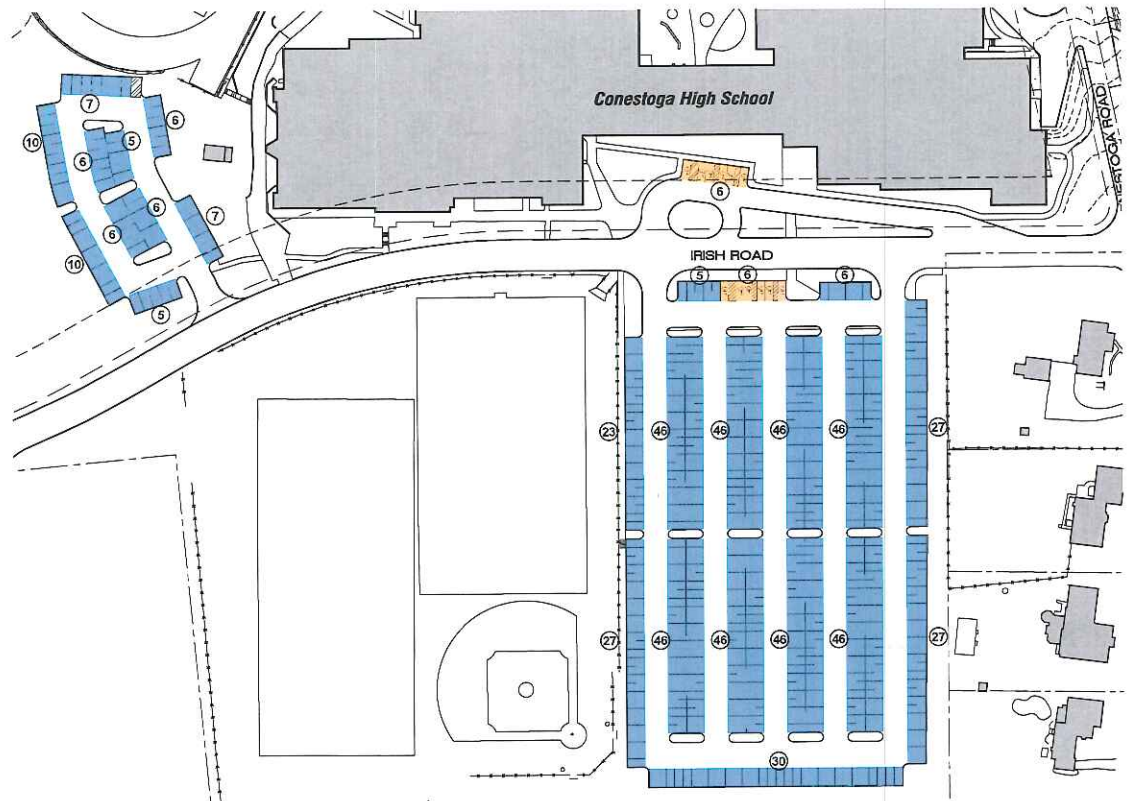

School	Existing Spaces 2008	Existing Spaces 2017		Existing HC Spaces	Existing HC Deficit	Needed/Requested Spaces (w/ Required HC)	Deficit Spaces	Total Spaces (See Note 1)
Conestoga High School	596	593	Note 6	12	0	578 (HC12)	0	593 (HC12)

DATA FROM DJA PARKING STUDY, 2017

TREDYFFRIN EASTTOWN MIDDLE SCHOOL

Daily Needs	Full Time	Part Time	Total	Comments
Teachers & Aides	98	0	98	
Itinerant Teachers & Staff		20	20	
Administration	3		3	
Support Staff / Sect.	3		3	
Visitors & Volunteers		6	6	
Service / Nurses	1	1	2	
Custodial Staff	7		7	
Cafeteria Staff	2	3	5	
Total			144	

Special Events	
	Many more than can be accommodated

Current Solutions
 When conditions allow they park on the athletic fields for limited events
 Park on surrounding streets, at the NOC, Conestoga HS and the Timothy School

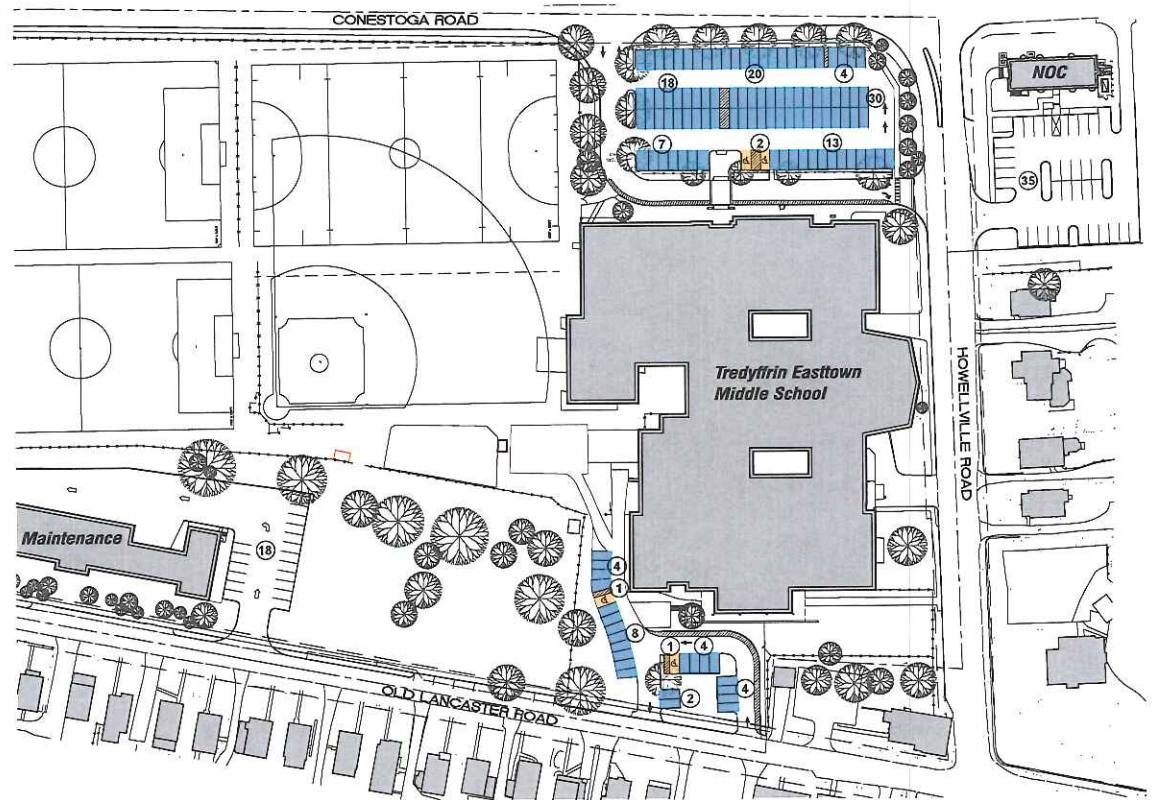

School	Existing Spaces 2008	Existing Spaces 2017		Existing HC Spaces	Existing HC Deficit	Needed/Requested Spaces (w/ Required HC)	Deficit Spaces	Total Spaces (See Note 1)
Tredyffrin / Easttown Middle School	117	118	Note 5	4	1	144 (HC5)	26	156 (HC5)

DATA FROM DJA PARKING STUDY, 2017

VALLEY FORGE MIDDLE SCHOOL

Daily Needs	Full Time	Part Time	Total	Comments
Teachers & Aides	111	0	111	
Itinerant Teachers & Staff	7	1	8	
Administration	3		3	
Support Staff / Sect.	4		4	
Visitors & Volunteers			25	
Service / Nurses		2	1	
Custodial Staff	7	1	8	
Cafeteria Staff	3	5	8	
Total			168	

Special Events

Many more than can be accommodated

Current Solutions

Park on streets surrounding school

Agreement with Church to use their parking lot

Additional parking at VFES

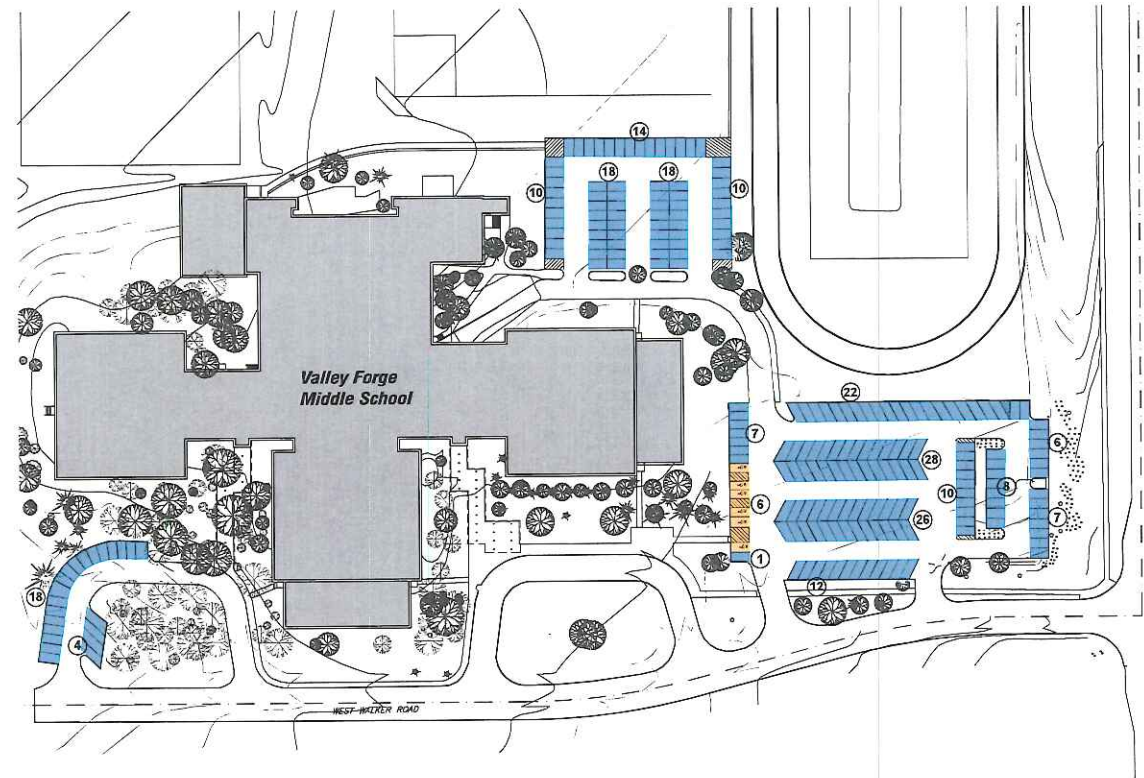

School	Existing Spaces 2008	Existing Spaces 2017	Existing HC Spaces	Existing HC Deficit	Needed/Requested Spaces (w/ Required HC)	Deficit Spaces	Total Spaces (See Note 1)
Valley Forge Middle School	221	225	6	1	168 (HC7)	0	225 (HC6)

DATA FROM DJA PARKING STUDY, 2017

VALLEY FORGE ELEMENTARY SCHOOL

Daily Needs	Full Time	Part Time	Total	Comments
Teachers & Aides	36	25	61	
Itinerant Teachers & Staff		10	10	
Administration	1		1	
Support Staff / Nurses	2		2	
Visitors & Volunteers		7	7	(a)
Service		1	1	
Custodial Staff	3	1	4	
Cafeteria Staff	4		4	
Total			90	

Special Events			
Pizza Bingo Nights		675	Held at CHS (b)
Opening Week Picnic		675	(b)
Spring Fair		675	(b)
Cultural Arts Program		20-250	(c)
Curriculum Nights		336	(d)
Book Fair		50-75	(e)

Comments:

(a) +/-25 / day and approx. 7 at any given time

(b) Principal used enrollment x 1.25

(c) Large attendances are evening events. Park on grass.



School	Existing Spaces 2008	Existing Spaces 2017	Existing HC Spaces	Existing HC Deficit	Needed/Requested Spaces (w/ Required HC)	Deficit Spaces	Total Spaces (See Note 1)
Valley Forge Elementary School	73	100	3	1	90 (HC4)	0	100 (HC3)

DATA FROM DJA PARKING STUDY, 2017

DJA PARKING STUDY

SUMMARY

School	A Existing Spaces 2008	B Existing Spaces 2017	C	D Existing HC Spaces	E Existing HC Deficit	F Needed/Requested Spaces (w/ Required HC)	G Deficit Spaces	H Total Spaces (See Note 1)
Beaumont Elementary School	83	88	Note 2	4	0	80-90 (HC4)	0	88 (HC4)
Devon Elementary School	76	104		5	0	89 (HC5)	0	104 (HC5)
Hillside Elementary School	58	65	Note 3	2	1	110 (HC5)	46	97 (HC3)
New Eagle Elementary School	58	94	Note 4	3	1	93 (HC4)	0	94 (HC3)
Valley Forge Elementary School	73	100		3	1	90 (HC4)	0	100 (HC3)
Tredyffrin / Easttown Middle School	117	118	Note 5	4	1	144 (HC5)	26	156 (HC5)
Valley Forge Middle School	221	225		6	1	168 (HC7)	0	225 (HC6)
Conestoga High School	596	593	Note 6	12	0	578 (HC12)	0	593 (HC12)

Notes:

The 'Spaces Needed' (column F) are based on the surveys returned by the Principals and indicates the number of HC spaces that would be required.

Parking spaces counted are 'off -street', 'striped' parking spaces

Accessible parking spaces required are as per IBC 2009, Section 1106

Note 1: Column 'H' is the total of spaces at each school. At Hillside and T/EMS this column indicates the totals after the proposed new additional parking.

NEES, VFES and VFMS should restripe spaces to address the HC deficit listed in column 'E'.

Note 2: In 1994 when seeking the Planning Commission approval the Township offered to allow the school to use the Township spaces across the street. That is when the sidewalk was installed from the District parking lot to Beaumont Road.

Note 3: There are three parking spaces that don't comply with the required adjacent aisle width, but are included in the 64 spaces (col. B). Some of these spaces were eliminated in the count in column 'H'. Column "H" does include the 8 spaces noted on the plan that require a variance due to slope.

Note 4: Fourteen spaces striped in the existing playground along the hill

Note 5: This does not include any of the 33 standard and 2 HC parking spaces at the NOC

Note 6: The majority of spaces are 8'-6" wide and restriping to the current ordinance width of 9' would mean the loss of 42 spaces. This count does not include the on-street spaces (not striped) on Old State Road.



CONESTOGA HIGH SCHOOL

EXTENDED BUS QUEUE ON OLD STATE ROAD



TPD TRAFFIC STUDY, APRIL 2017

EXISTING QUEUE CONDITION:

THIS OPTION WAS REMOVED DUE TO:

POSSIBLE ADDITION TO CHS LOCATION
AFFECTING THE PROPOSED ADDITIONAL
BUS QUEUING LANE.

PROPOSED PLAN

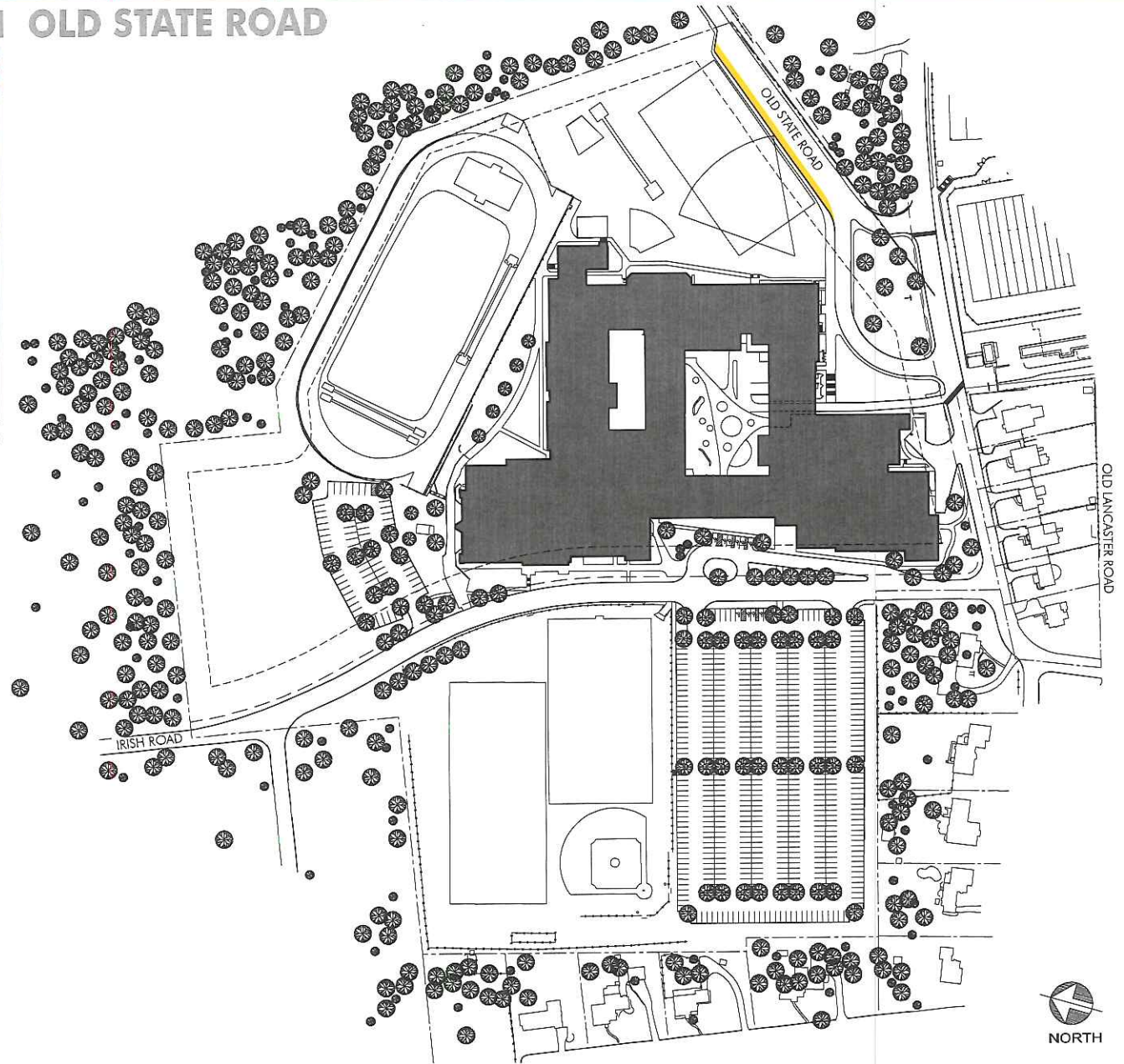

CONESTOGA HIGH SCHOOL

RIGHT TURN LANE INTO IRISH ROAD PARKING LOT

THIS OPTION WAS REMOVED DUE TO:

MINIMAL TRAFFIC IMPACT WHILE REDUCING
FIELD ACCESS, AND PEDESTRIAN CROSSWALK

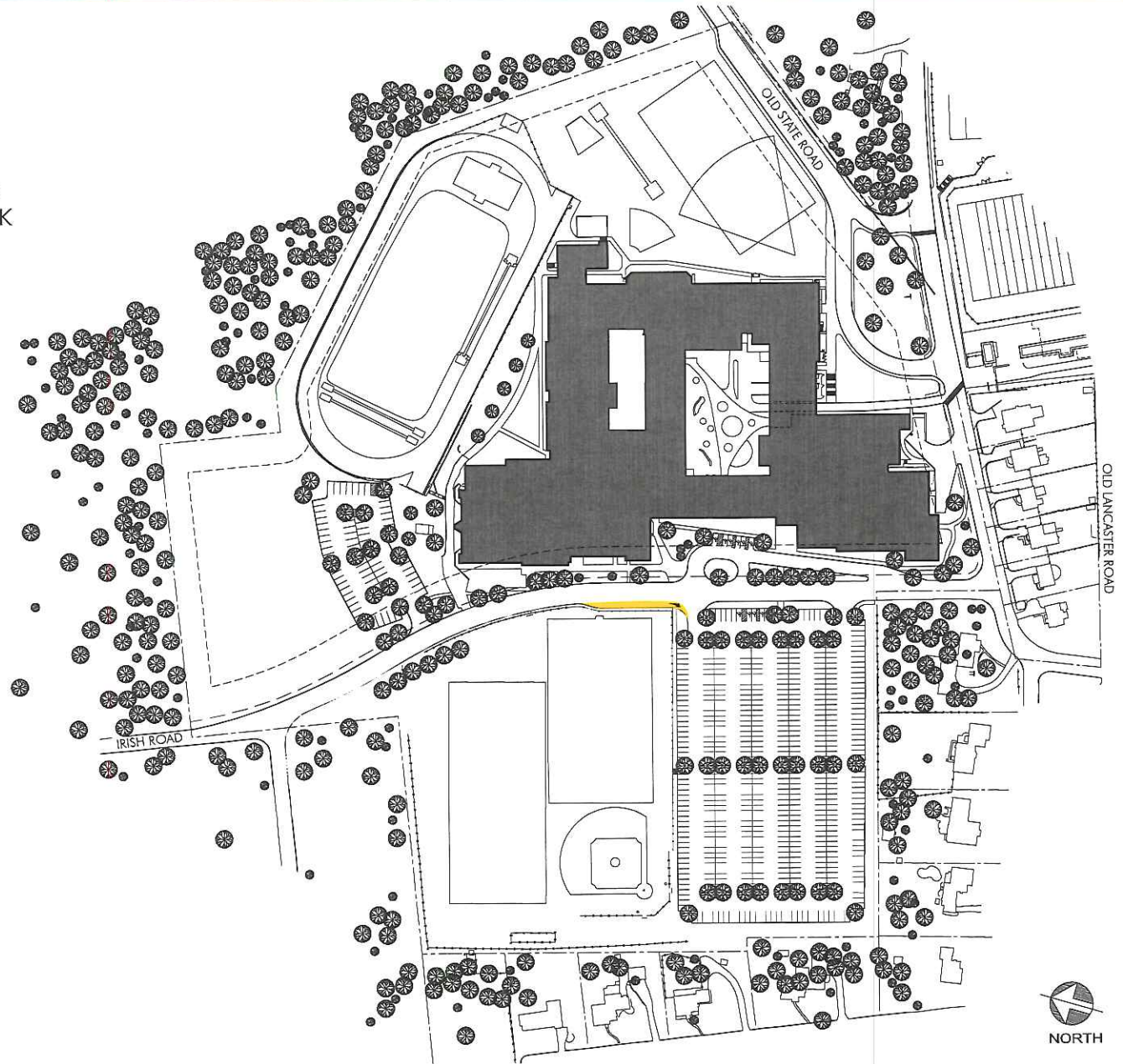

NORTH

PROPOSED PLAN

CONESTOGA HIGH SCHOOL

LOOP ROAD

THIS OPTION WAS REMOVED DUE TO:

POSSIBLE ADDITION TO CHS LOCATION
AFFECTING THE PROPOSED ADDITIONAL
QUEUING LANE.

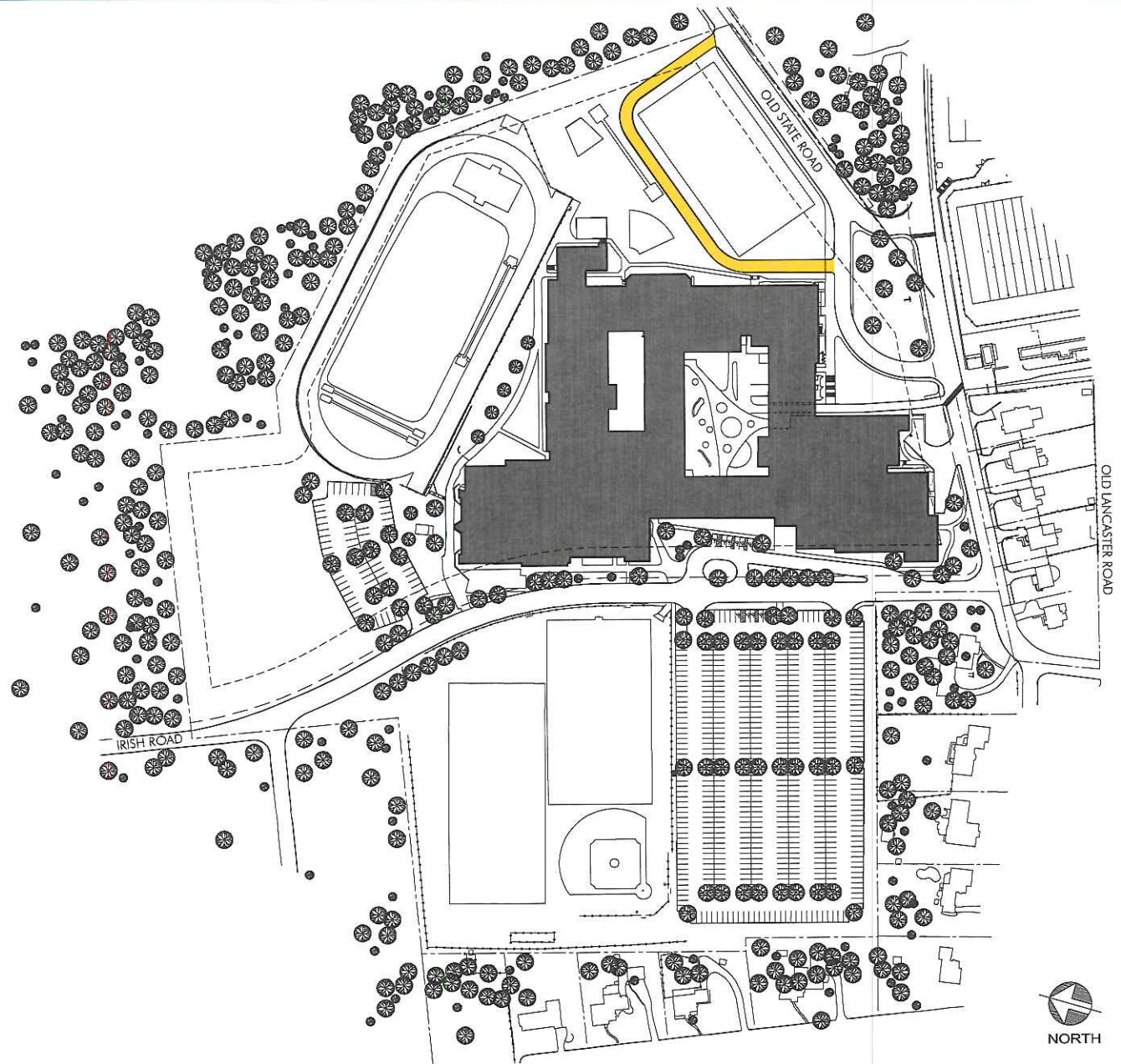

PROPOSED PLAN

TREDYFFRIN EASTTOWN MIDDLE SCHOOL

ADDITIONAL QUEUING AREA ALONG OLD LANCASTER ROAD

THIS OPTION WAS REMOVED AND
REDESIGNED TO ACCOMMODATE MORE
QUEUING CIRCULATION

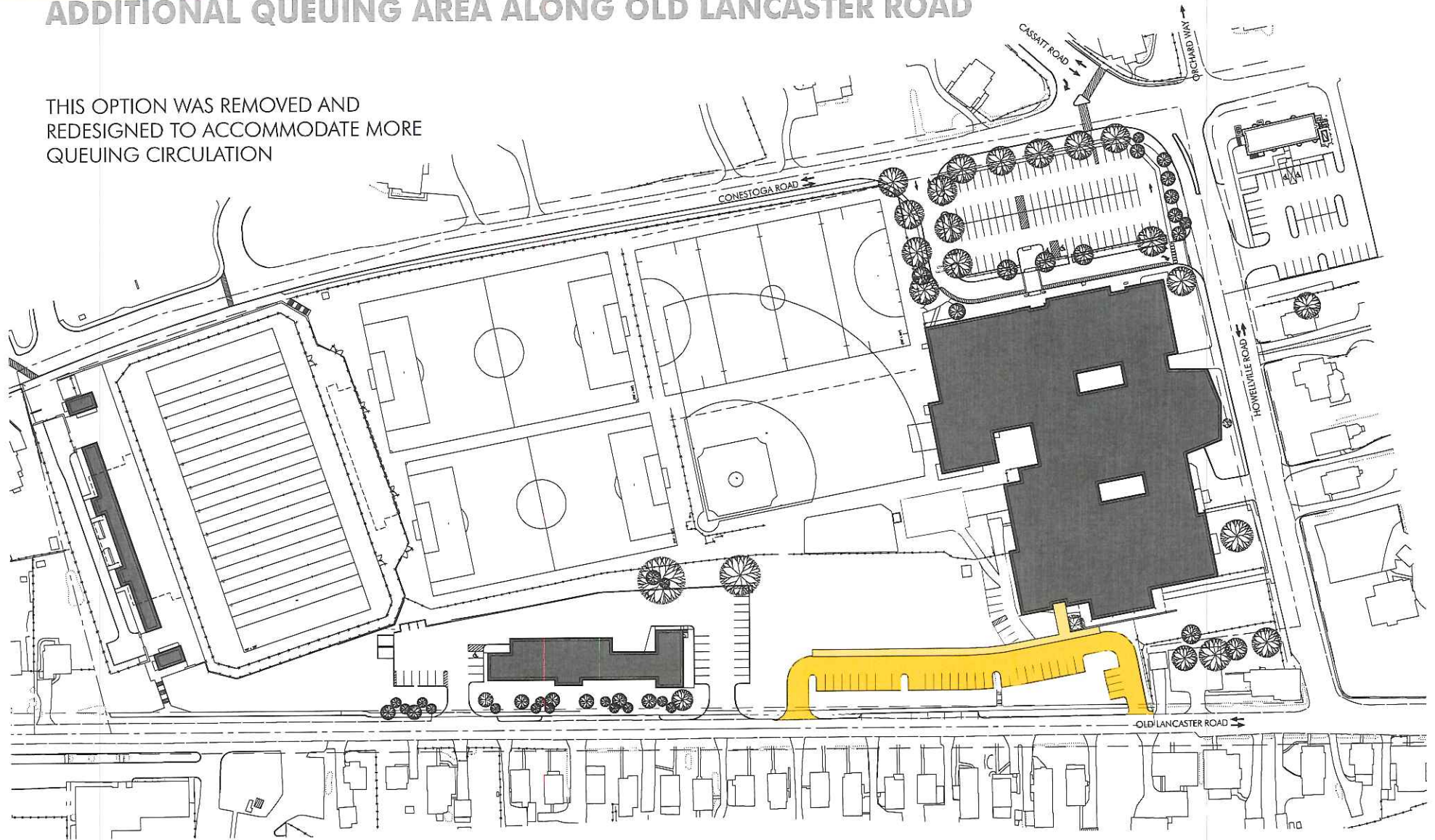

PROPOSED PLAN

TREDYFFRIN EASTTOWN MIDDLE SCHOOL

ADDITIONAL PARKING LOT AS PROPOSED BY DJA

THIS OPTION WAS REMOVED AND
REDESIGNED INTO THE ADDITIONAL
QUEUEING OPTION

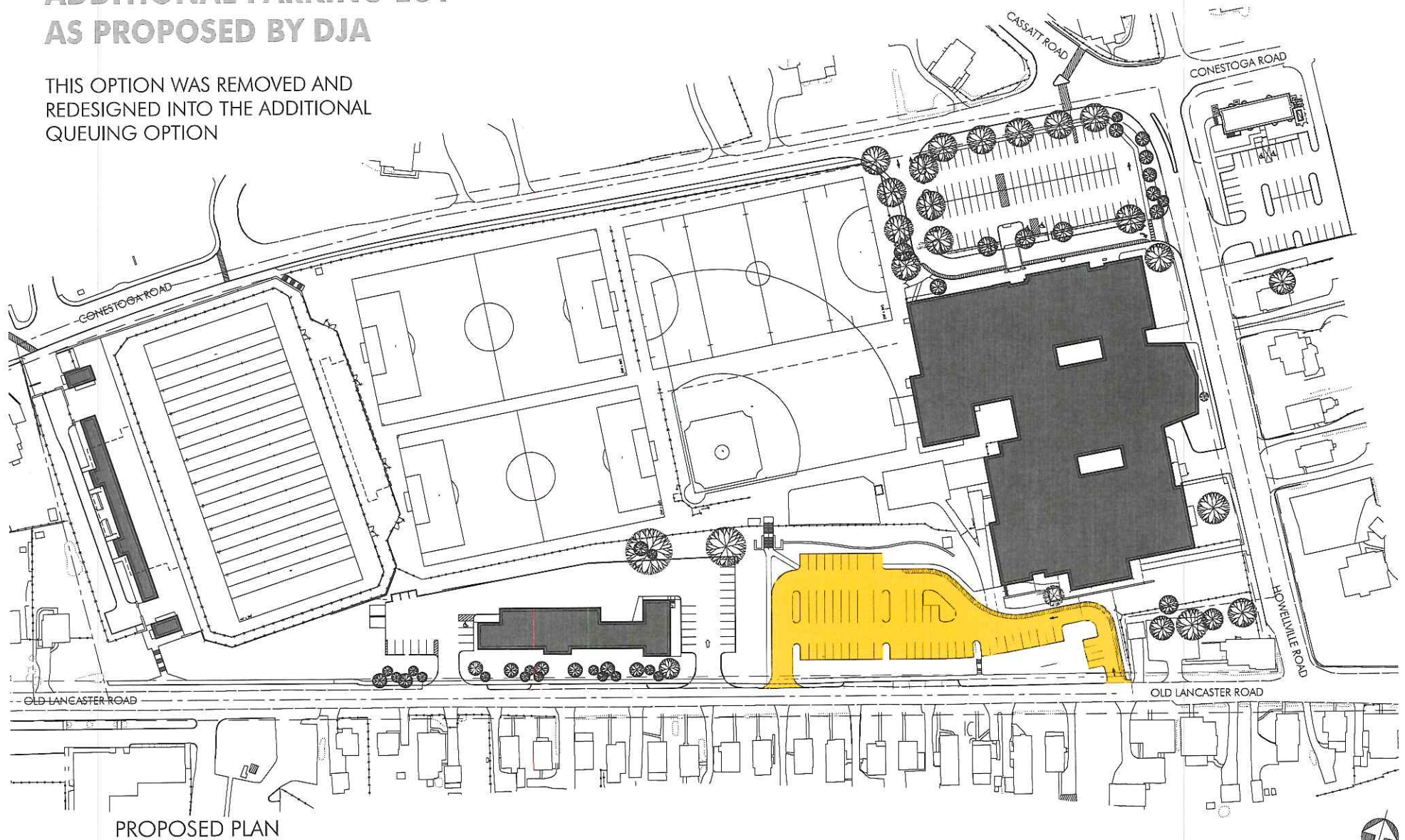

PROPOSED PLAN

VALLEY FORGE MIDDLE SCHOOL

SECONDARY DRIVEWAY WITH LEFT TURNS

THIS OPTION WAS REMOVED DUE TO:

CONCERN WITH THE SAFETY OF BEING
ABLE TO MAKE THE LEFT TURNS ACROSS
CHESTERBROOK BOULEVARD WITHIN
CLOSE PROXIMITY OF THE CURVE IN
CHESTERBROOK BOULEVARD



GOOGLE MAPS 3D VIEW

EXISTING SITE CONDITION

PROPOSED PLAN

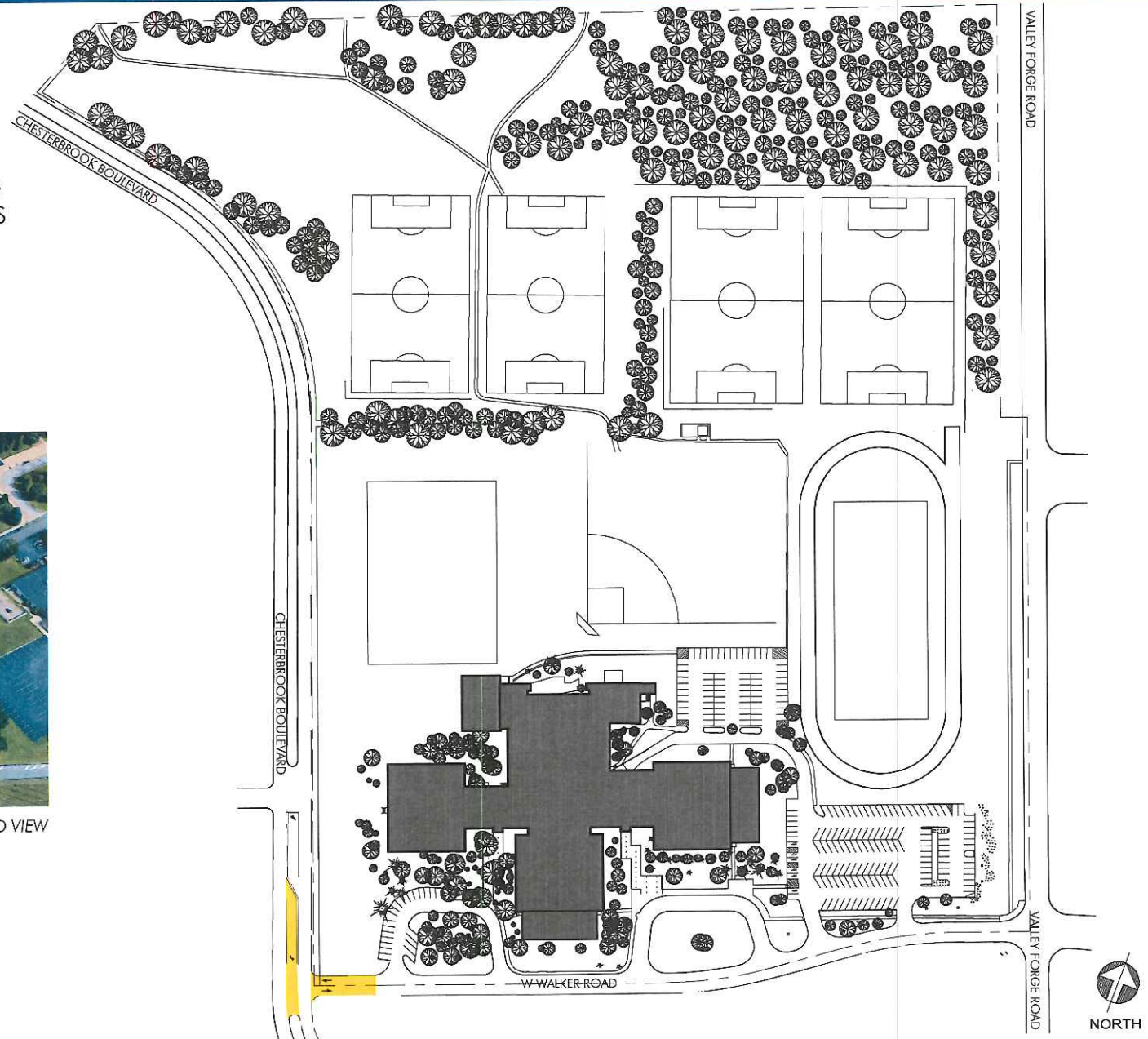

VALLEY FORGE ELEMENTARY SCHOOL

SECONDARY DRIVEWAY OFF OF EXISTING DRIVEWAY

THIS OPTION WAS REMOVED DUE TO:

THE NEW DRIVE LOCATION WAS GOING TO BE TOO CLOSE IN PROXIMITY TO THE EXISTING RETENTION BASIN.

THE DRIVEWAY CONFIGURATION STILL HAS VEHICLES AND BUSES ENTERING AND LEAVING THE SAME DRIVEWAY ENTRANCE.

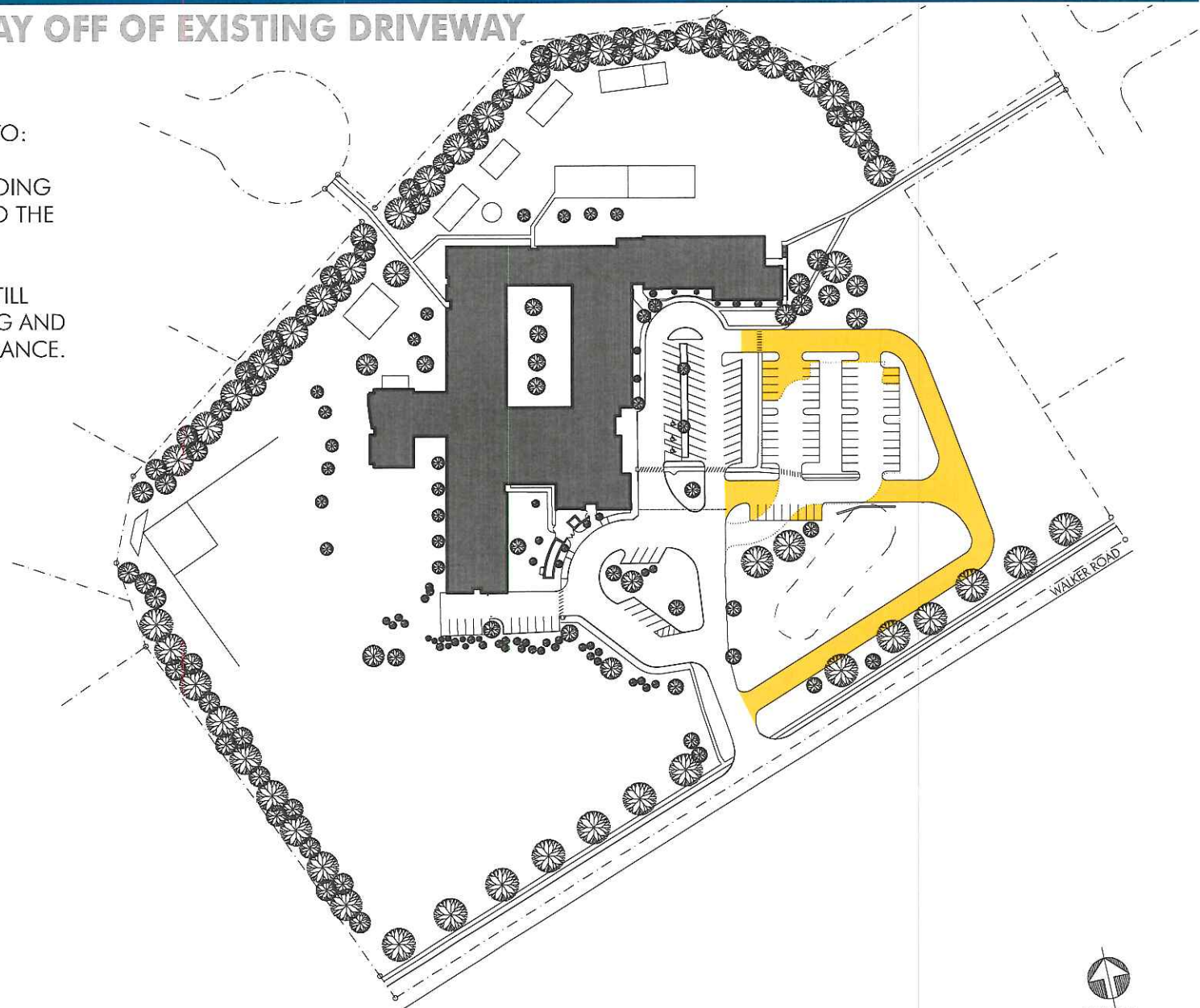

PROPOSED PLAN

VALLEY FORGE ELEMENTARY SCHOOL

SECONDARY DRIVEWAY WITH MIDDLE TURNING LANE IN WALKER ROAD

This option was removed due to the limited feasibility of constructing the large right of way area needed to be able to add a middle lane into Walker Road. Many challenges would need to be overcome in order to create this option; dedication of school property to the Township, removal of large trees, right of way would need to extend into private property, proximity to the Walker Road/Anthony Wayne Drive intersection not conducive to the transition space required. There would be extensive approvals and cost implications to this option. The middle lane would only be able to stack a minimal number of cars. This option does not solve the ongoing issue of stacked cars hindering the residents on Walker Road from turning into and backing out of their driveways.

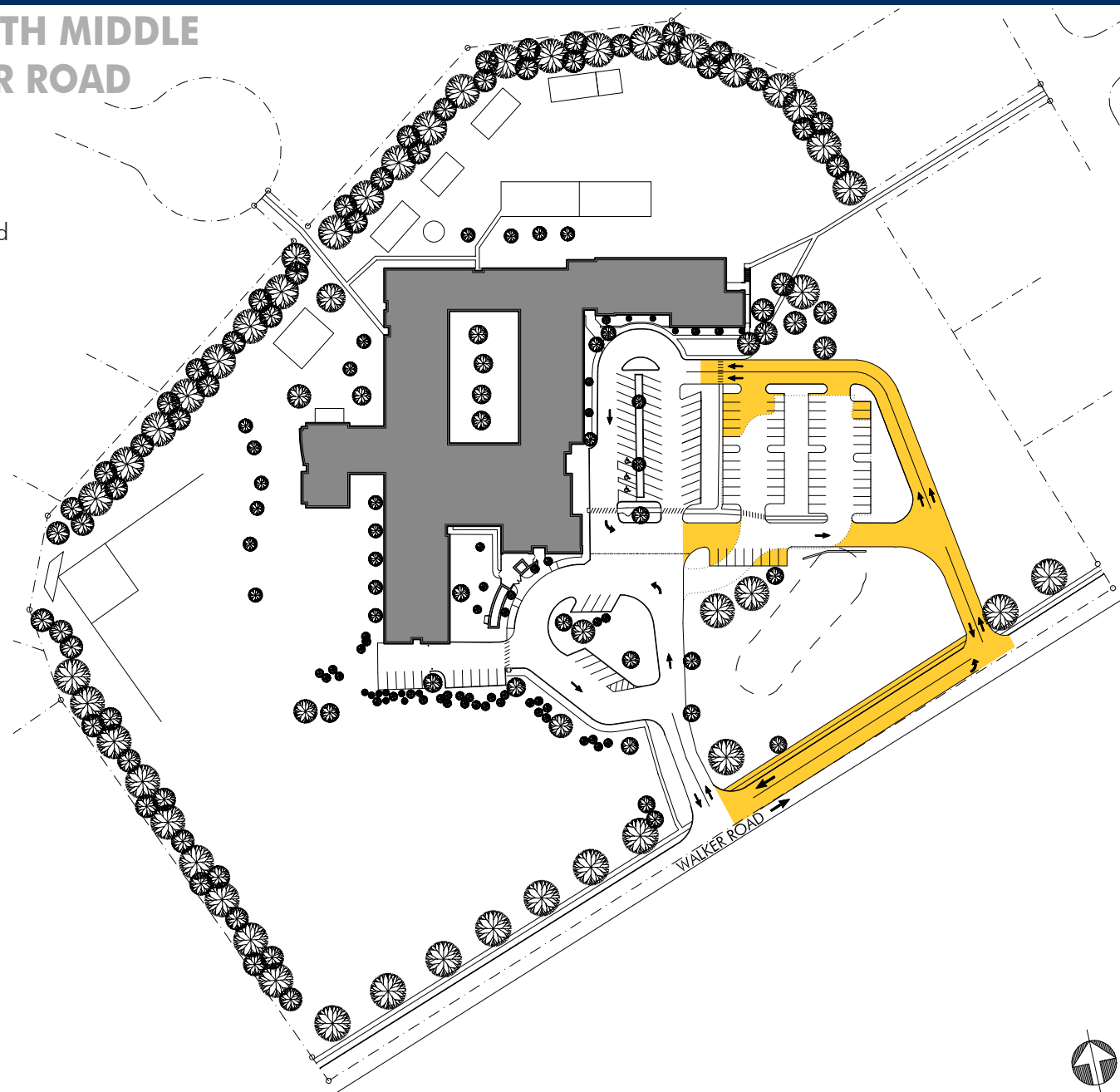

PROPOSED PLAN

